

Features of TELI's unique technology "Dual USB3"

About "Dual USB3"

- :: Toshiba Teli's unique interface technology that has the two channels of USB3 interface
- :: Keep the stability of conventional USB3, two times transfer bandwidth and output framerate

Features of "Dual USB3"

- 1: Keep using your TelicamSDK
- 2: Connect by USB3 Vision protocol
- 3: Transfer the data safely by USB3 Vision

USB3

DU Series

or single connection of DDU series

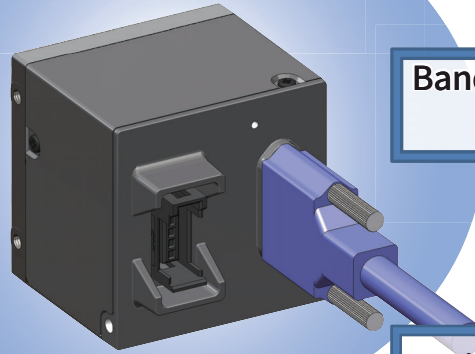

Bandwidth :
5 Gbps

Peripherals :
Cable 1
Board 1



USBTM
VISION



Bandwidth :
10 Gbps

2 times!



Peripherals :
Cable 2
Board 1

Just add
one cable !

Dual USB3

DDU Series

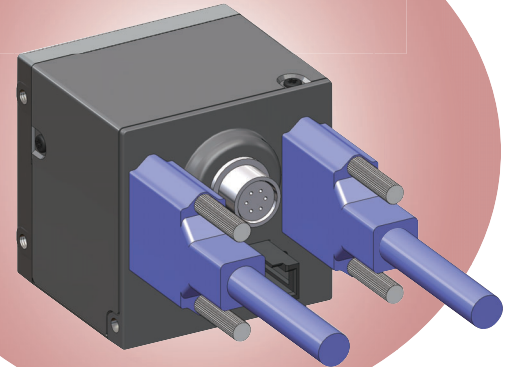

* USB3 Vision is trademark or registered trademark of AIA (Automated Imaging Association).

* The company names, product names, and standard names listed might be trademarks or registered trademarks of each company or organization.